

Components

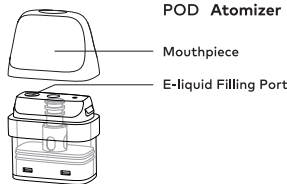

POD Atomizer

Mouthpiece

E-liquid Filling Port

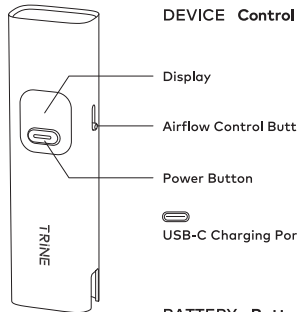

DEVICE Control

Display

Airflow Control Button

Power Button

USB-C Charging Port

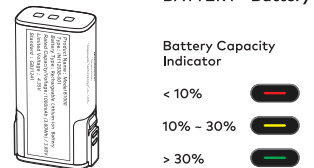

BATTERY Battery

Battery Capacity Indicator

< 10%

10% - 30%

> 30%

Fill and Install the Pod

1. How to fill

Remove the black mouthpiece to reveal the top-fill section and add e-liquid.



Important

- Wait for at least five minutes after filling to allow the new pod to saturate with E-liquid.
- Keep the pod from going completely empty of E-liquid. Refill it regularly to avoid dry hits or coil damage.



2. Insert the magnetic pod into the device.

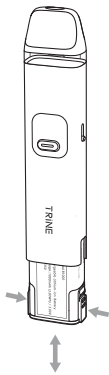

Adjusting the Airflow

Adjust the airflow control for your desired draw.

Power On/Off the Device

Press the power button three times within two seconds.

Installing and Removing the Battery

To remove the battery, pinch the snap joint on both sides and pull the battery downward. If you need to replace the battery, simply push the new battery into the device.

Home Screen



Puff Time

While vaping, the duration of your current draw will be displayed in seconds.



Adjusting the Wattage

- Double-click the power button to enter adjustment mode. When the power value flashes, click the power button to select the upward wattage value; it will loop from maximum to minimum.
- Press and hold the button again to enter the quick adjustment model.
- Wait for five seconds to exit the wattage setting.



EcoDrain™ (Self-discharging Mode)

While off, connecting the device to a charger and pressing the button 10 times quickly will make the device entire self-discharge mode. While in this mode, a recycling symbol will be shown on the display.

Charging

- Charge promptly based on battery level. Do not allow the battery to stay under 10% or above 90% for extended periods.
- Use a standard output charger and charging cable with the correct charging current and voltage range.
- Charging pauses when vaping and resumes when the button is let go.

Caution

- Turn the device off when not in use to avoid depleting the battery and minimize excess battery wear.
- Avoid dropping, throwing, or mishandling the device to prevent damage.
- Protect the device from direct sunlight, dust, moisture, or mechanical shock.
- Keep the device away from any water, liquid, or flammable gas.
- Keep the contents of this package out of reach of children, non-smokers and animals.
- Do not leave the device charging while unattended.
- Do not use it if pregnant or breast feeding.
- Warning: Do not use this product if you suffer from heart disease, severe hypertension, diabetes, stomach ulcers or have a history of seizures.

EEE Recycling

This product is meant to be disposed of in an approved e-waste receptacle or recycling bin. Do not throw it away in standard waste receptacles.

Specifications

Dimensions: 110.93×25.86×15.57 mm

Capacity: 2mL

Pod: Coil 0.6Ω (20-22W) /0.8Ω (12-14W) /1.2Ω (11-14W)

Output Power: 6.0-25.0W

Built-in Battery Capacity: 1000mAh

Charging Current: DC 5.0V/1.0A

Draw-activated Vape/ Button-activated Vape

Protections



Low Battery Protection
If the battery voltage is too low before or during vaping, the screen will display "LOW VOLT" and red light will flash 8 times.



No Load / High Resistance Protection
When no-load resistance or high resistance is detected, the screen will display "COIL CHECK" and green light will flash.



Short Circuit Protection
If low resistance is detected before vaping, the screen will display "LOW RES" and stay on for 5 seconds.
If low resistance is detected while vaping, the screen will display "COIL SHORT" and stay on for 5 seconds.



Auto-Shut Off Protection
If the power button is held for 10 seconds, the screen will display "TIME OUT" and flash 10 times.



Overheat Protection
When the PCBA (Printed Circuit Board Assembly) temperature sensor detects a high temperature, the screen will display "HIGH TEMP" and flash 3 times, then 3 times again.

WARRANTY CARD

CUSTOMER INFORMATION

Full Name

Mailing Address

Email

Telephone Number

PRODUCT INFORMATION

Product Name

Product Serial Number

Product Authentication Number

I certify that the above information is true. I agree to the terms and conditions of Innokin Technology's Warning Service Program and Privacy Policy.

INNOKIN TECHNOLOGY provides a 90 day after sales service warranty to all authorized vendors. Please consult the official Innokin website (www.innokin.com) or your Authorized Innokin Technology Vendor for more information and terms of service. The proof of purchase and the original box are needed for the 90 Day Limited Warranty.



VERIFY YOUR
INNOKIN PRODUCT



WARRANTY
INFORMATION

Print Name Signature Date