

Components

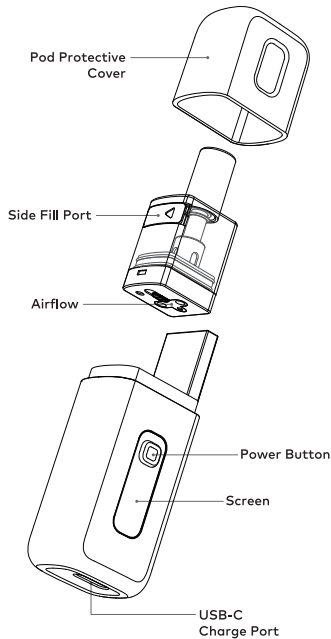

Filling the Pod

Remove the protective cover and open the rubber plug on the side to add E-liquid.

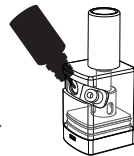

Important

- Wait for at least five minutes after filling to allow the new pod to saturate with E-liquid.
- Keep the pod from going completely empty of E-liquid. Refill it regularly to avoid dry hits or coil damage.

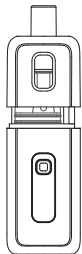

Installing and replacing the Pod from the Device

Magnetic pod: The pod can be removed directly from the device. When installing the pod, align the device with the corresponding hole under the pod. When the pod is installed, the atomizer resistance value (displayed with 2 decimal places) will be shown.



Adjusting the Airflow

The airflow switch is located on the bottom of the pod, where you'll find two air vents. By default, the bottom of the pod features single-hole ventilation. If you need double-hole ventilation, simply turn the black button to open a new vent.



Power On/Off the Device

Click the power button three times in two seconds continuously to turn the device on or off.

Interface



Wattage

Battery Level



Puff Time

When vaping the pod, the seconds of the current puff will be displayed, followed by the number of historical puffs



Adjusting the Wattage

Click the power button twice continuously. When the power value on the screen starts flashing, click the power button to select the upward wattage value; it will cycle from the minimum value again after reaching the maximum value. After the watt value is selected, wait for five seconds to exit the power setting.

Charging

- Charge promptly based on battery level.
- Use the provided charging cable and a standard output charger with the correct charging current and voltage range.
- Charging pauses during vaping and resumes after vaping.

Caution

- Turn the device off when not in use to avoid depleting the battery and minimize excess battery wear.
- Avoid dropping, throwing, or mishandling the device to prevent damage.
- Protect the device from direct sunlight, dust, moisture, or mechanical shock.
- Keep the device away from any water, liquid, or flammable gas.
- Keep the contents of this package out of reach of children, non-smokers and animals.
- Do not leave the charging device unattended.
- Do not use it if pregnant or breast feeding.
- Do not use it if you have an unstable heart condition, severe hypertension or diabetes.

EEE Recycling

This product should not be treated as household waste, instead it should be handed over to the applicable collection point for the recycling of electrical and electronic equipment.

Specifications

Dimensions: 26.5×21.5×82.25 mm

Capacity: 2mL

Pod: Coil 0.8Ω (12-14W); Coil 1.2Ω (9-12W)

Output Power: 6.0-15.0W

Built-in Battery Capacity: 700mAh

Charging Current: DC 5.0V/1.0A

Draw-activated Vape

Protections



Low Battery Protection
If the battery voltage is too low before or during vaping, the battery frame and LOGO on the display will flash 8 times.



No Load / High Resistance Protection
When no-load resistance or high resistance is detected, the screen will display "- - -" and flash.



Short Circuit Protection
If low resistance is detected the screen will display "- - -" and stay on for 5 seconds.



Auto-Shut Off Protection
If the power button is held for 10 seconds, the screen will display "- - -" and flash 10 times.



Overheat Protection
When the PCBA (Printed Circuit Board Assembly) temperature sensor detects a high temperature, the screen will display "- - -" and flash 3 times, then 3 times again.

WARRANTY CARD

CUSTOMER INFORMATION

Full Name
Mailing Address
Email
Telephone Number

PRODUCT INFORMATION

Product Name
Product Serial Number
Product Authentication Number

I certify that the above information is true. I agree to the terms and conditions of Innokin Technology's Warning Service Program and Privacy Policy.

INNOKIN TECHNOLOGY provides a 90 day after sales service warranty to all authorized vendors. Please consult the official Innokin website (www.innokin.com) or your Authorized Innokin Technology Vendor for more information and terms of service. The proof of purchase and the original box are needed for the 90 Day Limited Warranty.



VERIFY YOUR
INNOKIN PRODUCT



WARRANTY
INFORMATION

Print Name Signature Date